

CABLE 247 RF: RF CABLE ASSEMBLY, I-PEX MHF IV + SMA STRAIGHT PLUG + 0.81MM CABLE - 6GHz

SPECIFICATIONS

- 1. I-PEX MHF IV PLUG (20448-001R-081),
(ALTERNATIVE TO MURATA HSC)
- 2. 0.81MM COAXIAL CABLE, COLOR: GRAY
- 3. SMA STRAIGHT PLUG (RFCT-SMA023-M08)

NOTES:
1, ELECTRICAL
WORKING FREQUENCY RANGE: DC-6GHz

USAGE PRECAUTIONS: CABLES USING 'MICRO' COAX ARE DELICATE:
(i) HANDLE WITH CARE.
(ii) DO NOT TWIST; APPLY EXCESSIVE FORCES OR SHARP BENDS TO THE CABLE. DO NOT FORCEFULLY DEFORM WIRES.
(iii) CONSULT CONNECTOR MANUFACTURER'S DATASHEETS FOR DETAILED NOTES ON HANDLING INSTRUCTIONS.

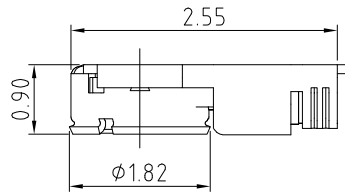
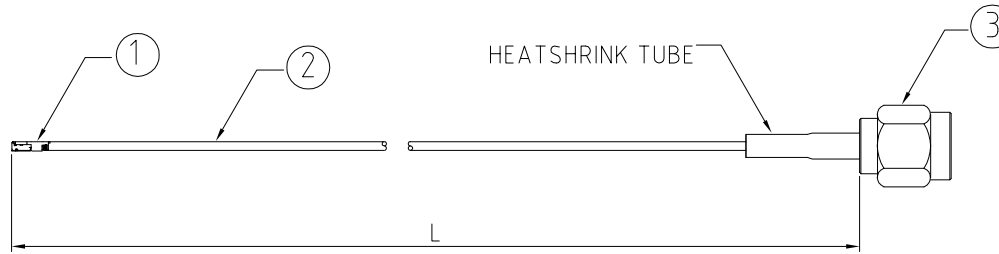

DETAIL I-PEX MHF IV

HOW TO ORDER

CABLE 247 RF - X X X

"L" LENGTH IN MM
eg: 100MM = 0100
(MIN. 025-MAX.400)
STANDARD = 100, 150, 200)
Tolerance: <50mm : ±2mm.
51-200mm: ±5mm.
201-400mm: ±7mm.

REV. DATE & DRN
1.0 18/08/'16 - RJH RELEASE
1.1 26/11/'20 - NYW
UPDATE SMA P/N

| | | | | | | |
|-------------------|----------------------|---|---|----------------------|--|---------------------|
| Scale: NTS | THIRD ANGLE | Unstated .X .XX .XXX ANGLES | Tolerances: N/A N/A N/A N/A | Material SEE NOTE | www.gradconn.com © THIS DRAWING IS CONFIDENTIAL AND MUST NOT BE COPIED OR DISCLOSED WITHOUT WRITTEN CONSENT | Type: Cable 247 RF |
| Drawn: RJH | | | | | | CABLE 247 RF |
| App'd: XXX | Title CABLE ASSEMBLY | NOT TO SCALE | | | | Drawing Number: |
| Date: 26 NOV. '20 | Revision: 1.1 | Unit: mm | | | | Sheet 1 of 1 |
| | | | | | | Drawing © E and O E |